

MARINE HARDWARE

船用五金

MARINE HARDWARE

QUALITY FIRST, COUSTOMERS FIRST



Bollard & Fairlead 系缆桩和导缆轮

AISI 316 STAINLESS STEEL BOLLARD SINGLE

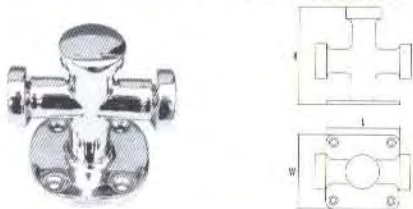

Code	L mm	W mm	H mm
H8100A	60	60	60

AISI 316 STAINLESS STEEL BOLLARD DOUBLE



Code	L mm	W mm	H mm
H8100B	120	60	60

AISI 316 STAINLESS STEEL BOLLARD



Code	L mm	W mm	H mm
H32120	120	95	120
H32150	150	120	150

AISI 316 STAINLESS STEEL BOLLARD

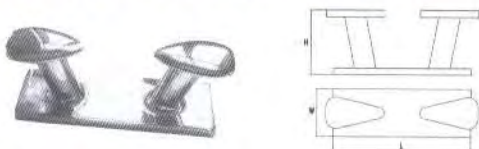

Code	L mm	W mm	H mm
H0501A	150	60	62
H0502A	200	70	77
H0503A	250	80	91
H0504A	300	90	109

MARINE HARDWARE

AISI 316 STAINLESS STEEL SLOTTED BOLLARD

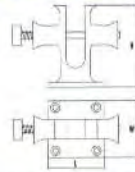
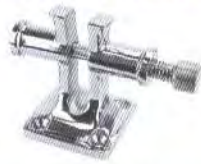

Code	L mm	W mm	H mm
H9000	61	61	86

AISI 316 STAINLESS STEEL FAIRLEAD FOR WINDLASS CHAIN AND PIPE



Code	Length mm	Size mm
H04209	130	90x90

AISI 316 STAINLESS STEEL FAIRLEAD ROLLER

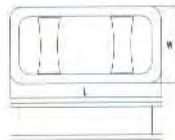

Code	L mm	W mm
H146226	340	160

AISI 316 STAINLESS STEEL FAIRLEAD ROLLER

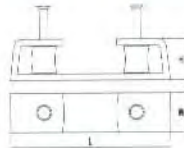

Code	L mm	W mm	H mm	Rope Size mm
H34205	205	40	55	16/22
H34260	260	45	75	24/30

AISI 316 STAINLESS STEEL HAWSE PIPE

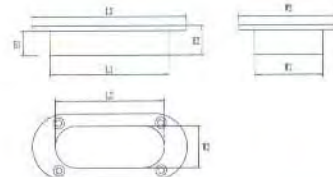

Code	L1 mm	L2 mm	L3 mm	W1 mm	W2 mm	W3 mm	H1 mm	H2 mm
H0800A	103	95	138	47	38	61	23	28
H0800C	188	175	237	88	75	136	24.6	30.6

AISI 316 STAINLESS STEEL HAWSE PIPE

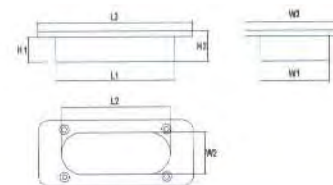

Code	L1 mm	L2 mm	L3 mm	W1 mm	W2 mm	W3 mm	H1 mm	H2 mm
H0800B	128	120	151	58	50	81	30.7	37.2

MARINE HARDWARE

MOORING & DOCKING

QUALITY FIRST, COUSTOMERS FIRST

Anchor 锚

AISI 316 STAINLESS STEEL BRUCE ANCHOR

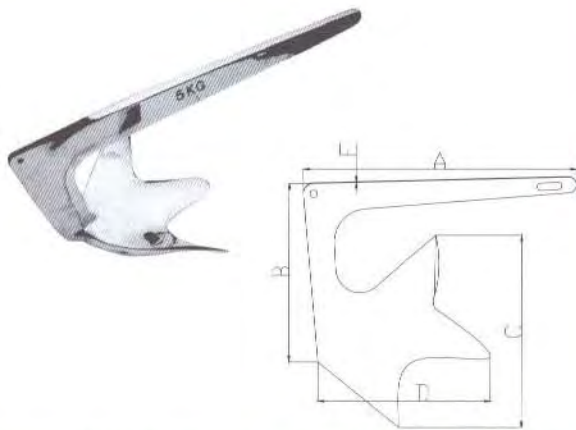

Code	A mm	B mm	C mm	D mm	Weight kg
H81005	215	90	145	105	0.5
H81010	265	110	183	130	1
H81020	350	150	220	175	2
H81025	400	160	220	200	2.5
H81030	410	170	235	200	3
H81035	435	170	235	220	3.5
H81040	435	180	285	230	4
H81050	470	190	310	270	5
H81075	530	210	360	290	7.5
H81100	600	228	380	320	10
H81120	600	235	435	350	12
H81130	600	235	435	350	13
H81150	670	265	450	360	15
H81200	715	360	470	390	20
H81250	735	360	515	410	25
H81300	815	360	550	460	30
H81400	935	370	660	460	40
H81500	1000	395	675	500	50

AISI 316 STAINLESS STEEL PLOUGH ANCHOR

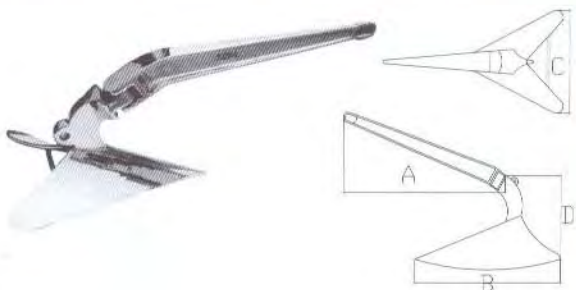

Code	A mm	B mm	C mm	D mm	Weight kg
H82020	330	260	190	160	2
H82050	510	340	260	220	5
H82070	560	380	270	230	7
H82090	600	375	280	250	9
H82100	620	400	290	270	10
H82120	660	430	340	300	12
H82150	730	490	360	330	15
H82200	740	550	370	360	20
H82220	750	550	370	390	22
H82270	780	600	460	360	27
H82340	800	630	480	360	34
H82350	820	640	490	380	35
H82500	950	750	540	440	50

MARINE HARDWARE

AISI 316 STAINLESS STEEL DELTA ANCHOR

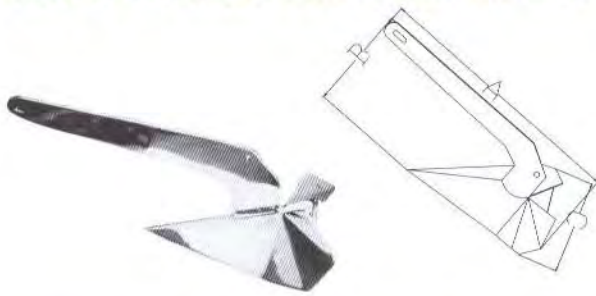

Code	A mm	B mm	C mm	Weight kg
H83015	350	160	155	1.5
H83020	410	190	185	2
H83050	550	240	210	5
H83080	610	250	240	8
H83100	660	280	275	10
H83150	720	335	310	15
H83200	860	385	355	20
H83300	970	420	370	30
H83400	1100	500	490	40
H83500	1200	550	540	50

AISI 316 STAINLESS STEEL DANFORTH ANCHOR

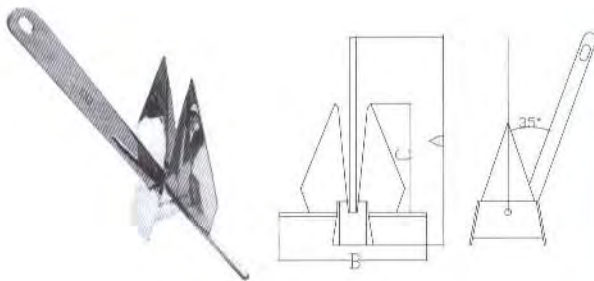

Code	A mm	B mm	C mm	Weight kg
H84015	370	280	230	1.5
H84020	390	300	260	2
H84025	400	320	260	2.5
H84030	410	340	290	3
H84035	420	360	290	3.5
H84040	480	380	310	4
H84045	500	400	310	4.5
H84050	510	430	330	5
H84055	540	450	330	5.5
H84060	590	460	340	6
H84065	630	470	340	6.5
H84080	650	480	350	8
H84090	670	500	370	9
H84100	750	520	420	10
H84120	830	540	430	12
H84150	880	600	455	15
H84200	960	650	520	20
H84300	1100	830	590	30
H84400	1100	900	670	40
H84500	1150	910	685	50
H84680	1300	950	750	68
H84800	1350	1000	765	80
H841000	1500	1200	950	100

AISI 316 STAINLESS STEEL GRAPNEL ANCHOR

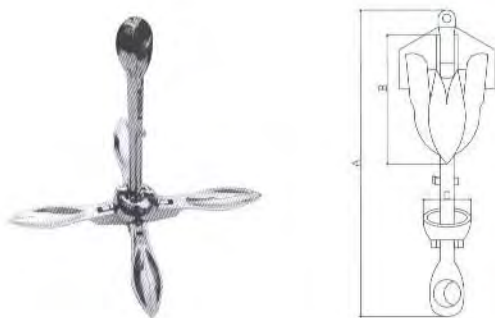

Code	A mm	B mm	C mm	Weight kg
H85007	200	90	47	0.7
H85015	302	135	54	1.5
H85025	355	156	59	2.5
H85032	395	174	73	3.2
H85040	460	200	76	4
H85050	470	210	80	5
H85060	523	222	85	6
H85070	530	230	90	7
H85080	600	240	90	8
H85100	655	260	102	10
H85120	840	326	102	12
H85160	900	326	102	16

AISI 316 STAINLESS STEEL FISHING ANCHOR



Code	Length mm
H86200	200
H86220	220
H86260	260

MARINE HARDWARE

HOT DIP GALVANIZED BRUCE ANCHOR



Code	Weight kg
H31010	1
H31020	2
H31035	3.5
H31050	5
H31075	7.5
H31100	10
H31150	15
H31200	20
H31300	30
H31500	50

HOT DIP GALVANIZED PLOUGH ANCHOR



Code	Weight kg
H32050	5
H32070	7
H32090	9
H32120	12
H32150	15
H32160	16
H32200	20
H32220	22
H32240	24
H32270	27
H32350	35

HOT DIP GALVANIZED DELTA ANCHOR



Code	Weight kg
H33005	0.5
H33010	1
H33020	2
H33040	4
H33060	6
H33075	7.5
H33100	10
H33160	16
H33200	20
H33250	25
H33320	32
H33400	40
H33500	50
H33630	63

HOT DIP GALVANIZED DANFORTH ANCHOR US TYPE



Code	Weight lb
H35040	4
H35060	6
H35080	8
H35130	13
H35140	14
H35180	18
H35220	22
H35250	25
H35265	26.5
H35330	33
H35400	40
H35700	70

MARINE HARDWARE

HOT DIP GALVANIZED GRAPNEL ANCHOR TYPE A



Code	Weight kg
H35015	1.5
H35025	2.5
H35032	3.2
H35040	4
H35060	6
H35080	8

HOT DIP GALVANIZED GRAPNEL ANCHOR TYPE B



Code	Weight kg
H36007	0.7
H36014	1.4
H36023	2.3
H36035	3.5
H36055	5.5
H36075	7.5
H36100	10
H36120	12
H36150	15

HOT DIP GALVANIZED HALL ANCHOR



Code	Weight kg
H37020	2
H37030	3
H37040	4
H37060	6
H37080	8
H37100	10

BLACK PAINTED HALL ANCHOR



Code	Weight kg
H38050	5
H38100	10
H38150	15
H38200	20
H38250	25
H38300	30

PVC COATED MUSHROOM ANCHOR



Code	Weight lb
H39080	8
H390100	10
H390120	12
H390150	15

MARINE HARDWARE

Windlass & Accessory

起锚机及配件



Max. working load (kgs/lbs): 180/400
 Max. pulling power (kgs/lbs): 540/1200
 Max. line speed (m/min)/(ft/min): 35/115
 Weight (kgs/lbs): 14/31
 Alt. 1-Chain (DIN766): 6mm
 Alt. 2-Chain/Rope (DIN 766-HT G4): 6mm-1/4"
 Alt. 3-Chain/Rope (DIN 766-HT G4): 8mm-5/16"
 Alt. 2-rope (mm-Inches): 12mm-1/2"
 Alt. 3-rope (mm-Inches): 14mm-9/16"
 With control units: Solenoids; Circuit breaker;
 Switch panel; Foot switch.
 Suitable for boats from 20ft to 35ft

AISI 316 STAINLESS STEEL

Code	Motor (W)	Voltage (V)	Current draw (A)
HW03A	600	12	20
HW03B	900	12	35



Max. working load (kgs/lbs): 150/330
 Max. pulling power (kgs/lbs): 450/990
 Max. line speed (m/min)/(ft/min): 26/85
 Weight (kgs/lbs): 9/20
 Alt. 1-Chain (DIN766): 6mm
 Alt. 2-Chain/Rope (DIN 766-HT G4): 6mm-1/4"
 Alt. 2-rope (mm-Inches): 12mm-1/2"
 With control units: Solenoids; Circuit breaker;
 Switch panel; Foot switch.
 Suitable for boats from 20ft to 35ft

AISI 316 STAINLESS STEEL

Code	Motor (W)	Voltage (V)	Current draw (A)
HW06A	600	12	33
HW06B	900	12	55



Max. working load (kgs/lbs): 150/330
 Max. pulling power (kgs/lbs): 450/990
 Max. line speed (m/min)/(ft/min): 26/85
 Weight (kgs/lbs): 10/22
 Alt. 1-Chain (DIN766): 6mm
 Alt. 2-Chain/Rope (DIN 766-HT G4): 6mm-1/4"
 Alt. 2-rope (mm-Inches): 12mm-1/2"
 With control units: Solenoids; Circuit breaker;
 Switch panel; Foot switch.
 Suitable for boats from 20ft to 35ft

AISI 316 STAINLESS STEEL

Code	Motor (W)	Voltage (V)	Current draw (A)
HW07A	600	12	33
HW07B	900	12	55



Round type
 Max. working load (kgs/lbs): 150/330
 Max. pulling power (kgs/lbs): 450/990
 Max. line speed (m/min)/(ft/min): 26/85
 Weight (kgs/lbs): 8/17.6
 Alt. 1-Chain (DIN766): 6mm
 Alt. 2-Chain (DIN 766-HT G4): 6mm-1/4"
 With control units: Solenoids; Circuit breaker;
 Switch panel; Foot switch.
 Suitable for boats from 20ft to 35ft

AISI 316 STAINLESS STEEL

Code	Motor (W)	Voltage (V)	Current draw (A)
HW12A	600	12	33
HW12B	900	12	55



Round type
 Max. working load (kgs/lbs): 150/330
 Max. pulling power (kgs/lbs): 450/990
 Max. line speed (m/min)/(ft/min): 26/85
 Weight (kgs/lbs): 10/22
 Alt. 1-Chain (DIN766): 6mm
 Alt. 2-Chain (DIN 766-HT G4): 6mm-1/4"
 Rope (mm-Inches): 12mm-1/2"
 With control units: Solenoids; Circuit breaker;
 Switch panel; Foot switch.
 Suitable for boats from 20ft to 35ft

AISI 316 STAINLESS STEEL

Code	Motor (W)	Voltage (V)	Current draw (A)
HW13A	600	12	33
HW23B	900	12	55

MARINE HARDWARE

Anchor Connector 锚链接器

AISI 316 STAINLESS STEEL ANCHOR CONNECTOR

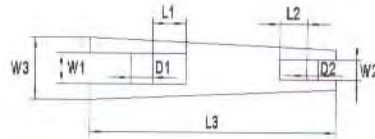

Code	L1 mm	L2 mm	L3 mm	W1 mm	W2 mm	W3 mm	D1 mm	D2 mm	Chain Size mm
H0901A	22	11	90.3	15	10	27.3	9.1	7	6-8
H0901B	25	11	113.7	18	12.6	36.2	10.7	10.7	8-10

AISI 316 STAINLESS STEEL ANCHOR CONNECTOR

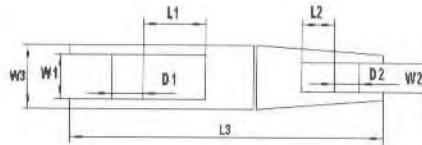

Code	L1 mm	L2 mm	L3 mm	W1 mm	W2 mm	W3 mm	D1 mm	D2 mm	Chain Size mm
H0902A	22.6	8.7	90	14.8	10	27.6	8.8	7	6-8
H0902B	28	10.5	115	17.8	13	38.5	10.6	10.6	8-10
H0902C	29.3	14.7	138	28	16.1	53.4	14.6	12.5	10-12

AISI 316 STAINLESS STEEL ANCHOR CONNECTOR

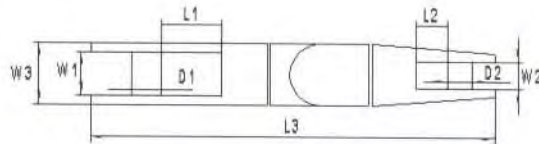

Code	L1 mm	L2 mm	L3 mm	W1 mm	W2 mm	W3 mm	D1 mm	D2 mm	Chain Size mm
H0903A	20.9	9.4	118	14.5	10	26.7	8.9	7	6-8
H0903B	26.7	11.6	165	17.8	13.1	37.7	10.6	10.7	8-10

AISI 316 STAINLESS STEEL ANCHOR CONNECTOR

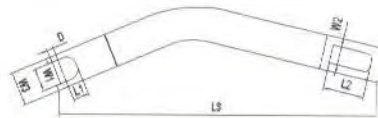

Code	L1 mm	L2 mm	L3 mm	W1 mm	W2 mm	W3 mm	D mm	Chain Size mm
H050810	9.3	20.8	220	11	11	27	7.7	6-8
H050812	14	23	300	13	13	36	10.7	8-10

AISI 316 STAINLESS STEEL ANCHOR CHAIN LOCK



Code	Chain Size mm
H050603	6-8
H050604	8-10

MARINE HARDWARE

Bow Roller 锚支架

AISI 316 STAINLESS STEEL BOW ROLLER FOR BRUCE ANCHOR

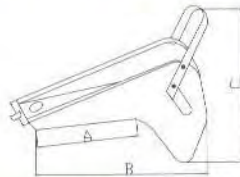

Code	For anchors kg	For chain mm	Length mm	Height mm
H04201	10	6/8	380	196
H04202	15	8/10	480	240
H04203	20	10/12	590	235
H04204	30	10/12	590	240

AISI 316 STAINLESS STEEL BOW ROLLER FOR DELTA ANCHOR

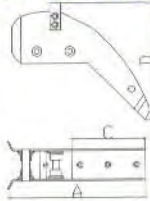

Code	For anchors kg	Length mm	Height mm
H04208	6/10	620	83
H04211	16/25	670	85

AISI 316 STAINLESS STEEL BOW ROLLER FOR INFLATABLES



Code	Size mm
H04213	185x210

AISI 316 STAINLESS STEEL BOW ROLLER FOR INFLATABLES

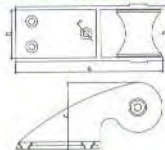

Code	Size mm
H04215	160x62

AISI 316 STAINLESS STEEL BOW ROLLER FOR DELTA ANCHOR

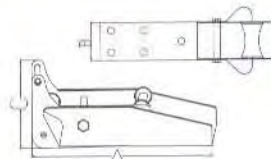

Code	For anchors kg	Height mm	Size mm
H04217	8	70	328x96
H04220	13	100	430x160

AISI 316 STAINLESS STEEL BOW ROLLER

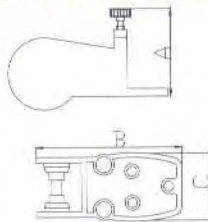

Code	Length mm	Height mm
H05000	205	155

AISI 316 STAINLESS STEEL BOW ROLLER

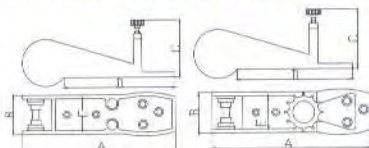

Code	Length mm	Height mm
H05001	340	160

MARINE HARDWARE

AISI 316 STAINLESS STEEL BOW ROLLER

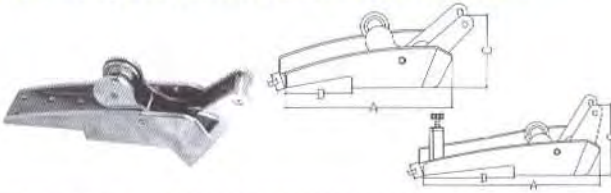

Code	For anchors kg	For chain mm	Height mm	Length mm	Width mm
H4214	12	6/8	62	410	85
H4216	15	8/10	88	530	102

AISI 316 STAINLESS STEEL BOW ROLLER



Code	For anchors kg	Length mm	Width mm
H4234	7.5-15	420	76
H4235	10-20	600	76
H4236	30-40	725	90
H4237	50-60	890	100
H4275	15-30	750	90
H4295	30-50	950	95

AISI 316 STAINLESS STEEL BOW ROLLER



Code	Length mm	Width mm
H0001	570	110

SELFLAUNCHING BOW ROLLERS



Code	Length mm	Width mm	Anchor Size
H4242	420/16.5"	76/3"	7.5-15kg,16.5-33lbs

SELFLAUNCHING BOW ROLLERS



Code	Length mm	Width mm	Anchor Size
H4256	600/23.2"	76/3"	10-20kg,22-44lbs

SELFLAUNCHING BOW ROLLERS



Code	Length mm	Width mm	Anchor Size
H4257	750/29.5"	90/3.5"	15-30kg,33-66lbs

SELFLAUNCHING BOW ROLLERS



Code	Length mm	Width mm	Anchor Size
H4259	950/37.4"	95/3.7"	30-50kg,66-100lbs

AISI 316 STAINLESS STEEL SINGLE WHEEL ROLLER



Code	Length mm	Width mm
H0003	155	51

MARINE HARDWARE

AISI 316 STAINLESS STEEL BOW ROLLER WITH ANCHOR BLOCKING DEVICE



Code	Length mm	Width mm
H0004	230	55

AISI 316 STAINLESS STEEL BOW ROLLER WITH ANCHOR BLOCKING DEVICE



Code	Length mm	Width mm
H0005	250	47

AISI 316 STAINLESS STEEL BOW ROLLER



Code	Length mm	Width mm
H0006	55	68

AISI 316 STAINLESS STEEL BOW ROLLER



Code	Length mm	Width mm
H0007	200	97

AISI 316 STAINLESS STEEL BOW ROLLER



Code	Length mm	Width mm
H0008	156	50

AISI 316 STAINLESS STEEL BOW ROLLER



Code	Length mm	Width mm
H0009	160	87

AISI 316 STAINLESS STEEL BOW ROLLER



Code	Length mm	Width mm
H0010	390	50
H0011	590	100
H0012	455	87

MARINE HARDWARE

Cleat 索栓

AISI 316 STAINLESS STEEL HOLLOW BASE CLEAT

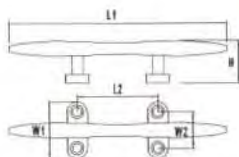

Code	L1 mm	L2 mm	W1 mm	W2 mm	H mm
H0002A	100	48	36	22	25
H0002B	125	54	39	25	27
H0003A	150	56	44	26	31
H0005C	200	75	50.9	28	41
H0006C	250	95	65	44	50
H0007D	300	98	70	48	52
H0007E	375	113	78	52	56

AISI 316 STAINLESS STEEL HOLLOW BASE CLEAT HEAVY DUTY

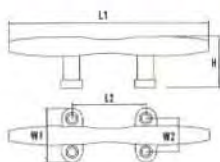

Code	L1 mm	L2 mm	W1 mm	W2 mm	H mm
H0002C	100	50.6	36.6	22.7	26.5
H0002D	125	56.4	38	25	29.1
H0003B	150	57	43	26	31
H0005D	200	72.7	54.6	32.2	38
H0006D	250	94.5	66	46.8	44
H0007C	300	98.5	71	49	53

AISI 316 STAINLESS STEEL SILHOUETTE CLEAT

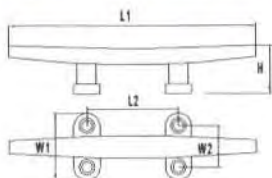

Code	L1 mm	L2 mm	W1 mm	W2 mm	H mm
H0004A	100	29	36	24	25
H0004B	125	41	46	29	25
H0004C	150	40	56	39	28
H0004D	200	49	62	44	31
H0004E	250	57	64	45	40

AISI 316 STAINLESS STEEL MAST CLEAT

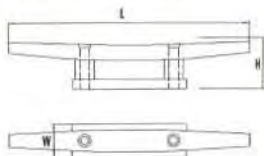

Code	L mm	W mm	H mm
H0009A	100	13	30
H0009B	125	17	35.5
H0009C	150	19	39.5
H0009D	200	23	45.2
H0009E	250	24.2	47.7

AISI 316 STAINLESS STEEL MAST CLEAT

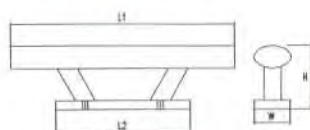

Code	L1 mm	L2 mm	W mm	H mm
H33150	150	118	19	53
H33205	205	137	34	56
H33265	265	150	40	68
H33310	310	175	50	78
H33311W	310	175	100	78

AISI 316 STAINLESS STEEL HUMPBACKED CLEAT

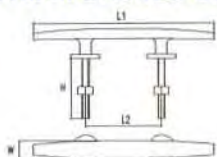

Code	L1 mm	L2 mm	W mm	H mm
H35150	150	63.5	18	45
H35200	200	84	22.5	45
H35250	250	106.4	28.3	45

MARINE HARDWARE

AISI 316 STAINLESS STEEL HUMPBACKED CLEAT



Code	L1 mm	L2 mm	W mm	H mm
H34150	150	46.1	15.6	47.3
H34200	200	58.2	20	47.3
H34250	250	74.6	24.5	47.3

HOLLOW BASE FALT CLEAT

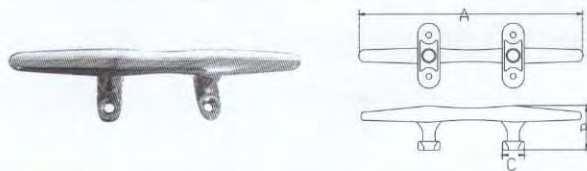

Code	Length
H1001	6"
H1002	8"
H1003	10"

AISI 316 STAINLESS STEEL CLEAT



Code	L mm	W mm	H mm
H1210	125	31	51.5
H1211	150	31	61.5
H1212	200	46	86.5
H1213	250	58	104
H1214	300	70	106

AISI 316 STAINLESS STEEL CLEAT



Code	L mm	W mm	H mm
H0003D	125	26	50
H0005E	150	45	62

AISI 316 STAINLESS STEEL CLEAT



Code	L mm	W mm	H1 mm	H2 mm
H0003E	125	26	44	45
H0003F	150	45	56	45

AISI 316 STAINLESS STEEL CLEAT



Code	L mm	H mm
H32180	180	30
H32240	240	43
H32300	300	60
H32350	350	75

AISI 316 STAINLESS STEEL CLEAT



Code	L mm	H mm
H2252	220	52
H2258	260	58
H2265	300	65

MARINE HARDWARE

AISI 316 STAINLESS STEEL CLEAT MODEL "SAIL"

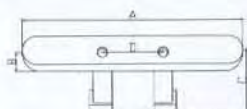

Code	Length mm.	H mm.	On center mm.
H2260	220	52	60
H2270	260	58	70
H2281	300	65	81

AISI 316 STAINLESS STEEL CLEAT K



Code	L mm	H mm
H37215	215	47.5

AISI 316 STAINLESS STEEL CLEAT

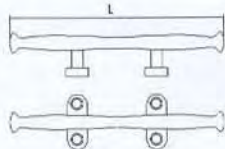

Code	L mm
H0007A	155

AISI 316 STAINLESS STEEL CLEAT

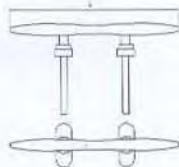
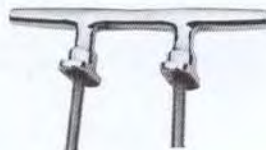

Code	L mm
H0003C	150

AISI 316 STAINLESS STEEL CLEAT



Code	L mm
H1411	150

AISI 316 STAINLESS STEEL RING CLEAT COMBI

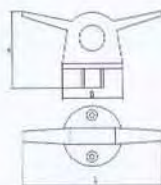

Code	L mm	D mm	H mm
H0008A	175	62	68

AISI 316 STAINLESS STEEL CLEAT

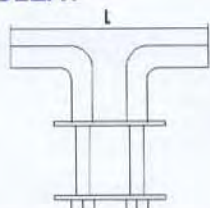

Code	L mm
H0006A	295

MARINE HARDWARE

AISI 316 STAINLESS STEEL MAST CLEAT



Code	Dia mm.
H0002E	6"
H0002F	4-1/2"

AISI 316 STAINLESS STEEL CLEAT



Code	Length
H0005A	6"

AISI 316 STAINLESS STEEL CLEAT



Code	Length
H0007B	6-1/5"

AISI 316 STAINLESS STEEL REINFORCEMENT FOR CLEAT MODEL "DUNE"



Code	Suitable for cleat
H2565	34150
H3590	34200
H5010	34250

AISI 316 STAINLESS STEEL CLEAT INOX FOR ROPES

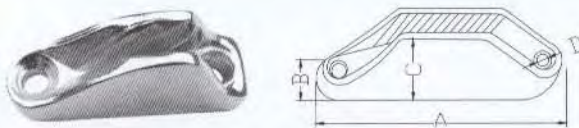

Code	Length mm	Width mm
H1221	48	7.2

AISI 316 STAINLESS STEEL CLEAT INOX FOR ROPES



Code	Length mm	Width mm
H1222	53.3	15

AISI 316 STAINLESS STEEL CLEAT INOX FOR ROPES

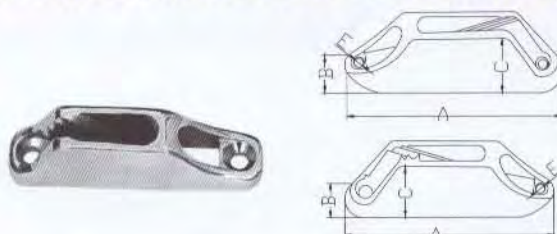

Code	Length mm	Width mm
H1223	55	16.5
H1224	81	16

MARINE HARDWARE

Chock 导缆器

AISI 316 STAINLESS STEEL HEAVY DUTY STRAIGHT CHOCK

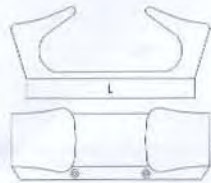
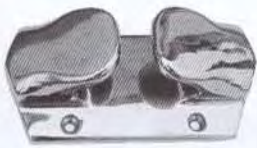

Code	L mm
H1035	196

AISI 316 STAINLESS STEEL HEAVY DUTY STRAIGHT CHOCK

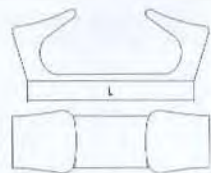

Code	L mm
H1036	196

AISI 316 STAINLESS STEEL TRIANGLE BOW CHOCK

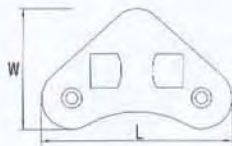

Code	L mm	W mm
H1039	107	65

AISI 316 STAINLESS STEEL BOW CHOCKS

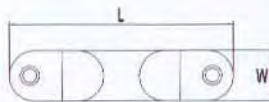

Code	L mm	W mm
H0014A	100	19
H0014B	125	19
H0014C	150	22
H0014D	200	38
H0014E	250	44

AISI 316 STAINLESS STEEL BOW CHOCK



Code	L mm	W mm
H0011B	150	35
H0011C	200	38
H0011D	250	44

MARINE HARDWARE

AISI 316 STAINLESS STEEL BOW CHOCK



Code	L mm	W mm
H0012A	114	19
H0012B	150	22

AISI 316 STAINLESS STEEL BOW CHOCK

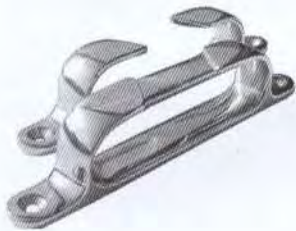

Code	L mm	W mm
H0013A	114	19
H0013B	150	22
H0013C	200	38

AISI 316 STAINLESS STEEL BOW CHOCK

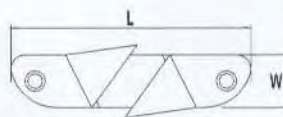

Code	L mm	W mm
H0010A	114	19
H0011A	150	26

AISI 316 STAINLESS STEEL BOW CHOCK

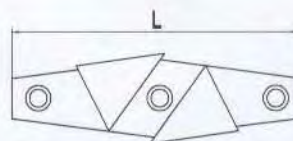
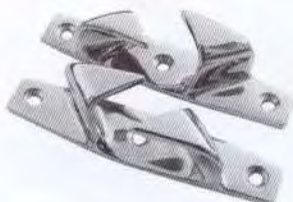

Code	L mm
H01240	114
H01241	150

MARINE HARDWARE

Handle 扶手

AISI 316 STAINLESS STEEL HANDRAIL



Code	Dia. Of Pipe mm	Length mm
H30150	25	300
H30152	25	400
H30154	25	500
H30155	25	600

AISI 316 STAINLESS STEEL HANDRAIL WITH ROUND BASE



Code	Dia. Of Pipe mm	Length mm
H30160	22	200
H30162	22	300
H30163	22	400
H30164	22	500
H30165	22	600
H30166	22	800
H30170	22	1000

AISI 316 STAINLESS STEEL HANDRAIL WITH OVAL BASE



Code	Dia. Of Pipe mm	Length mm
H31160	22	200
H31162	22	300
H31163	22	400
H31164	22	500
H31165	22	600
H31166	22	800

S.S HEAVY DUTY OVAL HANDRAIL W/FLANGE & STUD

Made of 304 Stainless Steel



Code	Stud to stud Distance	Oval Tube
H02561	304.8	25.4x18.8
H02562	406.8	25.4x18.8
H02563	457.2	25.4x18.8
H02564	609.6	25.4x18.8
H02565	219.1	25.4x18.8

S.S OVAL HANDRAIL

Made of 316 Stainless Steel



Code	Length	Tube Size
H8201	12"	13x13
H8202	18"	13x13
H8203	24"	13x13
H8204	18"	20x40
H8205	24"	20x40
H8206	30"	20x40
H8207	36"	20x40
H8208	48"	20x40
H8209	60"	20x40
H8210	72"	20x40

S.S OVAL HANDRAIL

Made of 304 Stainless Steel



Code	Length	Oval Tube
H02571	12"	25.4x18.8
H02572	16"	25.4x18.8
H02573	18"	25.4x18.8
H02574	24"	25.4x18.8
H02575	9"	25.4x18.8

MARINE HARDWARE

AISI 316 STAINLESS STEEL HANDRAIL



Code	L mm	H mm	Fixing
H0171A	170	40	2 Studs 1/4"
H0172A	170	40	2 Screws 1/4"

HANDRAILS

Made of 316 Stainless Steel



Code	Fixing mm	LxH mm
H0301A	2Studs	300x50
H0302A	2Screws	300x50

AISI 316 STAINLESS STEEL HANDRAIL



Code	L mm	H mm
H400101	120	27
H400102	150	45

AISI 316 STAINLESS STEEL HANDRAIL



Code	L mm	H mm
H52001	150	50

AISI 316 STAINLESS STEEL HANDRAIL



Code	L mm	H mm
H60118	67	15.5
H60119	82	19.5
H60120	102.5	24.5

MARINE HARDWARE

Top Cap & Slide 滑帽&滑套

AISI 316 STAINLESS STEEL TOP CAP



Code	D2 mm	W mm	H mm	D1 mm
H0400B	19	6	58	6
H0401A	22	6	58	6
H0402A	25	6	58	6
H0402C(heavy)	25	7	58	8
H0403A	30	9	64	10

AISI 316 STAINLESS STEEL TOP CAP



Code	D2 mm	W mm	H mm	D1 mm
H0401B	19	6	65	8
H0402B	22	6	65	8
H0403B	30	6	65	8

TOP CAPS

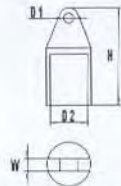

Code	Pipe
H203-1501	7/8"
H203-1502	1"

AISI 316 STAINLESS STEEL TOP TERMINAL CAP



Code	L mm
H22116	22
H22117	25
H22118	30

AISI 316 STAINLESS STEEL TOP ADJUST CAP

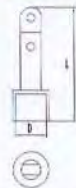

Code	D mm	L mm
H22120	22	135
H25120	25	135
H30120	30	144

AISI 316 STAINLESS STEEL TOP CAP



Code	D mm
H202-1502	25

AISI 316 STAINLESS STEEL TOP CAP



Code	D mm
H202-1503	25

MARINE HARDWARE

AISI 316 STAINLESS STEEL TOP SLIDE

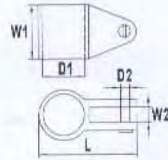

Code	D1 mm	L mm	W1 mm	W2 mm	D2 mm
H0400A	19	44	22.5	6.5	6
H0405A	22	51	28	8	6
H0406A	25	54	28.5	8	6
H0407A	30	66	26.5	8	6

AISI 316 STAINLESS STEEL TOP SLIDE

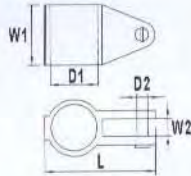

Code	D1 mm	L mm	W1 mm	W2 mm	D2 mm
H0405B	22	60	30	7.5	6
H0406B	25	62	31	8	6

AISI 316 STAINLESS STEEL TOP SLIDE

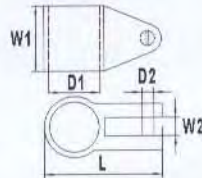

Code	D1 mm	L mm	W1 mm	W2 mm	D2 mm
H0408A	22	54.3	28	10.6	7
H0408B	25	57	29	11	7
H0408C	30	62	29.5	11.5	7

AISI 316 STAINLESS STEEL TOP SLIDE

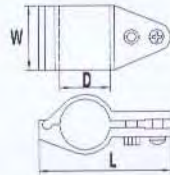

Code	D mm	L mm	W mm
H0298A	22	71	30
H0298B	25	75	31
H0298C	30	84	32

AISI 316 STAINLESS STEEL TOP SLIDE

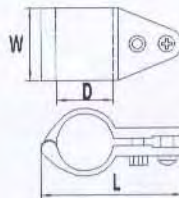

Code	D mm	L mm	W mm
H204-1400	22	57	27
H204-1401	25	70	28
H204-1402	30	78	29

AISI 316 STAINLESS STEEL TOP SLIDE

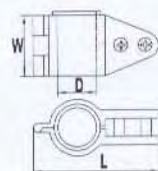

Code	D mm	L mm	W mm
H02951	20	75	28
H02952	22	75	28
H02953	25	75	28

MARINE HARDWARE

AISI 316 STAINLESS STEEL TOP SLIDE

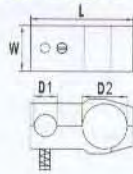

Code	D2 mm	L mm	W mm	D1 mm
H202-1501	25	82	50	20

AISI 316 STAINLESS STEEL CLAMP

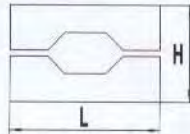

Code	L mm	H mm	For Pipe mm
H0018A	54.3	30	22/25

AISI 316 STAINLESS STEEL CLAMP

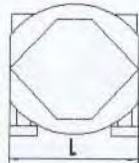

Code	L mm	For Pipe mm
H0018B	62.4	30/35~40

AISI 316 STAINLESS STEEL TOP CAP+SLIDE



Code	pipe
H0412A	1"

AISI 316 STAINLESS STEEL TOP CAP+SLIDE



Code	pipe
H0412B	1"

AISI 316 STAINLESS STEEL TENT SLIDING BRACKETR

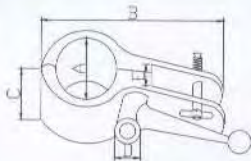
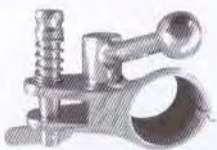

Code	For pipe mm.
H22100	22
H2299	25

AISI 316 STAINLESS STEEL FLAGPOLE SLEEVE BASE

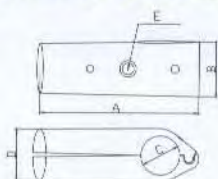

Code	For pulpit mm.	Flagpole mm.
H04947	25	20-25
H04948	30	20-25

MARINE HARDWARE

Deck Hinge 山型座

AISI 316 STAINLESS STEEL DECK HINGE 90°



Code	L mm	W mm
H0409E	52	17

AISI 316 STAINLESS STEEL DECK HINGE 90°

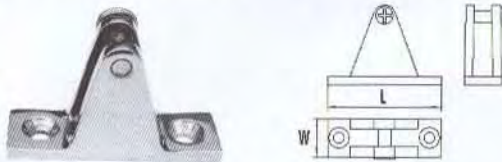

Code	L mm	W mm
H0409A	52	17

AISI 316 STAINLESS STEEL DECK HINGE 90°

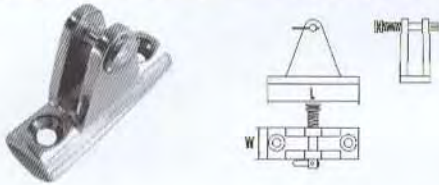

Code	L mm	H mm	For Pipe mm
H0609A	52	17	22

AISI 316 STAINLESS STEEL DECK HINGE 90°

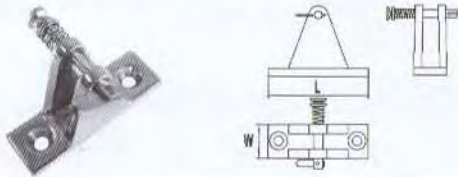

Code	L mm	W mm
H0409B	52	17

AISI 316 STAINLESS STEEL DECK HINGE 90°

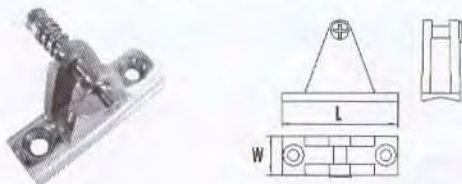

Code	L mm	W mm	For Pipe mm
H0611D	52	17	22

AISI 316 STAINLESS STEEL DECK HINGE 90°



Code	Size
H0609A	7/8"
H0611A	1"

MARINE HARDWARE

AISI 316 STAINLESS STEEL DECK HINGE 90°

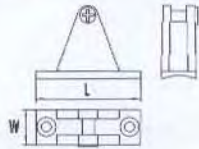

Code	L mm	W mm	For Pipe mm
H0611B	52	17	22

AISI 316 STAINLESS STEEL INCLINED DECK HINGE

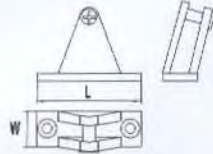

Code	L mm	W mm
H0611I	52	17

AISI 316 STAINLESS STEEL INCLINED DECK HINGE

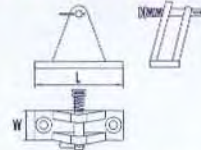

Code	L mm	W mm
H0611J	50	17

AISI 316 STAINLESS STEEL DECK HINGE

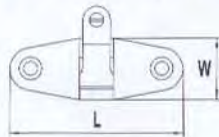

Code	L mm	W mm
H22101	70	25

AISI 316 STAINLESS STEEL DECK HINGE

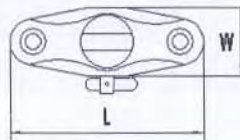

Code	L mm	W mm
H22102	90	39

AISI 316 STAINLESS STEEL DECK HINGE

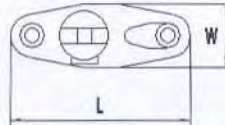

Code	L mm	W mm
H22201	81	32
H22202	90	30

AISI 316 STAINLESS STEEL DECK HINGE

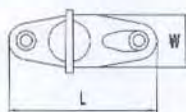

Code	L mm	W mm
H22203	90	30

AISI 316 STAINLESS STEEL DECK HINGE

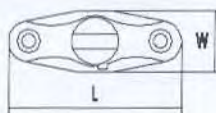

Code	L mm	W mm
H202-1500	94	40.8

MARINE HARDWARE

Rod Holder 鱼竿座

AISI 316 STAINLESS STEEL ROD HOLDER

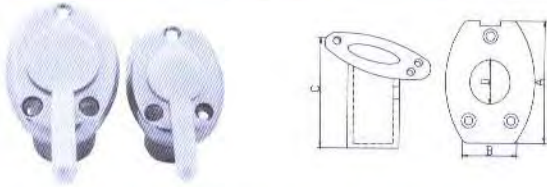

Code	Base size mm.
H4954	22
H4956	25

AISI 316 STAINLESS STEEL ROD HOLDER



Code	For pipe size.	Rod holder I.D
H7741	1"	1-3/4"
H7742	1-1/4"	1-3/4"
H7743	1-3/4"	1-3/4"

AISI 316 STAINLESS STEEL ROD HOLDER

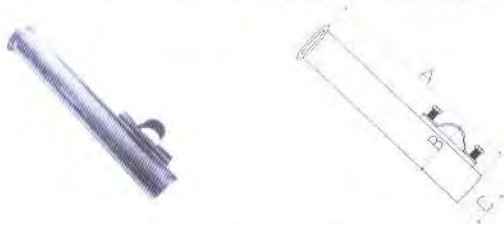

Code	I.D. mm.
H7753	34

AISI 316 STAINLESS STEEL ROD HOLDER



Code	Clamp	Length	I.D.
H7762	S.S 316	9"	1-5/8"

AISI 316 STAINLESS STEEL ROD HOLDER

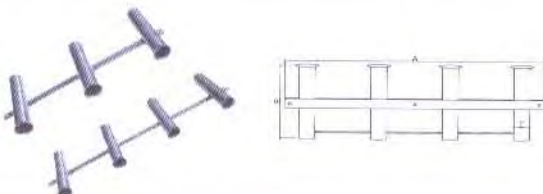

Code	Size mm.
H7756	44.5x528x193
H7757	44.5x725x193

AISI 316 STAINLESS STEEL ROD HOLDER



Code	D mm	L2 mm	L1 mm	W mm
H7751	42.5	292	90	60

AISI 316 STAINLESS STEEL ROD HOLDER



Code	D mm	L mm	For Pipe mm
H7750	42.5	315	25

MARINE HARDWARE

AISI 316 STAINLESS STEEL ROD HOLDER



Code	D mm	L mm	For Pipe mm	Degree
H7739	42.5	240	25	30°

AISI 316 STAINLESS STEEL ROD HOLDER



Code	D mm	L mm	Degree
H7745SR	42	230	30°

AISI 316 STAINLESS STEEL ROD HOLDER



Code	D mm	L mm	Degree
H7745S	42	230	30°

AISI 316 STAINLESS STEEL ROD HOLDER



Code	D mm	L mm	Degree	Cap	Hole
H1230S	42	230	30°	No	No
H1231S	42	230	30°	Yes	No

AISI 316 STAINLESS STEEL ROD HOLDER



Code	D mm	L mm	For Pipe mm
H7744SN	42	230	22-25

AISI 304 STAINLESS STEEL FISHING ROD HOLDER

Suitable For 1" Rail



Code	D mm	L mm	Installation Position
H517	41	245	Rail

AISI 304 STAINLESS STEEL FISHING ROD HOLDER

Suitable For 1" Rail



Code	D mm	L mm	Installation Position
H519	41	245	Rail

MARINE HARDWARE

Handrail bracket 扶栏支架

AISI 316 STAINLESS STEEL HANDRAIL STANCHION (60° FORWARD) 60°

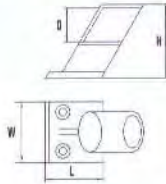

Code	D mm	L mm	W mm	H mm
H0220A	22	31.8	41.3	45.1
H0220B	25	31.8	40	56

AISI 316 STAINLESS STEEL HANDRAIL STANCHION (60° CENTER)

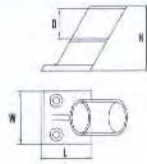

Code	D mm	L mm	W mm	H mm
H0221A	22	31.8	41.3	45.1
H0221B	25	31.8	40	56

AISI 316 STAINLESS STEEL HANDRAIL STANCHION (60° END)

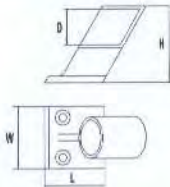

Code	D mm	L mm	W mm	H mm
H0222A	22	31.8	41.3	45.1
H0224A	25	31.8	40	56

AISI 316 STAINLESS STEEL HANDRAIL STANCHION (60° END)

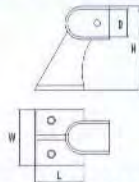

Code	D mm	L mm	W mm	H mm
H0225A	22	32	39	67.7
H0225B	25	32.2	37	69.6

AISI 316 STAINLESS STEEL HANDRAIL STANCHION (60° CENTER)

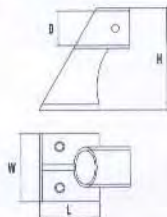

Code	D mm	L mm	W mm	H mm
H0226A	22	31.8	36.6	66.2
H0226B	25	31.5	36	69.2

AISI 316 STAINLESS STEEL HANDRAIL STANCHION (60° CENTER)

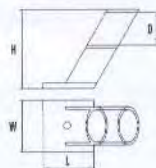

Code	D mm	L mm	W mm	H mm
H0228A	22	31.5	34.4	47.4
H0228B	25	33.7	34.8	54.7

MARINE HARDWARE

Pipe Stanchion 管座

AISI 316 STAINLESS STEEL 30° HANDRAIL ROUND BASE

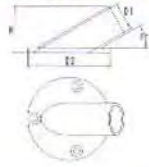

Code	D1 mm	D2 mm	H mm
H0202A	22	66.3	37.8
H0202B	25	72.2	36.7

AISI 316 STAINLESS STEEL 45° HANDRAIL ROUND BASE

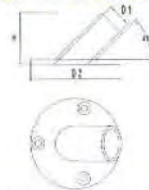

Code	D1 mm	D2 mm	H mm
H0203A	22	66.3	38.1
H0203B	25	72.2	37.9

AISI 316 STAINLESS STEEL 60° HANDRAIL ROUND BASE

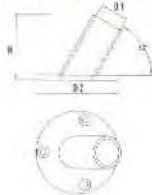

Code	D1 mm	D2 mm	H mm
H0205A	22	66.3	41.1
H0206A	25	72.2	40
H0206B	30	71.5	46

AISI 316 STAINLESS STEEL 90° HANDRAIL ROUND BASE

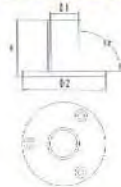

Code	D1 mm	D2 mm	H mm
H0207A	22	66.3	44.7
H0208A	25	72.2	44.7
H0208B	30	71.5	43.2

AISI 316 STAINLESS STEEL 90° SHORT HANDRAIL ROUND BASE

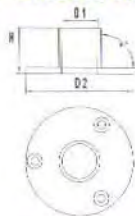

Code	D1 mm	D2 mm	H mm
H0207C	22	66.3	28
H0208C	25	72.2	29

AISI 316 STAINLESS STEEL 30° HANDRAIL RECTANGULAR BASE

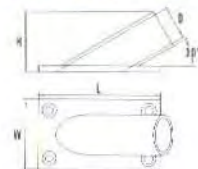

Code	D mm	L mm	W mm	H mm
H0209A	22	78.7	44	35.6
H0209B	25	82	47.3	38

AISI 316 STAINLESS STEEL HANDRAIL STANCHION (60° CENTER)

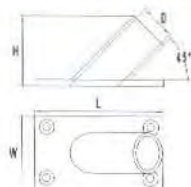

Code	D mm	L mm	W mm	H mm
H0210A	22	78.7	44	39
H0210B	25	82	47.3	43.6

MARINE HARDWARE

AISI 316 STAINLESS STEEL 60° HANDRAIL RECTANGULAR BASE

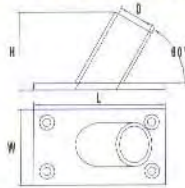

Code	D mm	L mm	W mm	H mm
H0211B	22	78.7	44	45.5
H0212B	25	82	47.3	49.8
H0212C	30	85.6	51.6	42.4

AISI 316 STAINLESS STEEL 90° HANDRAIL RECTANGULAR BASE

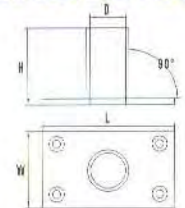
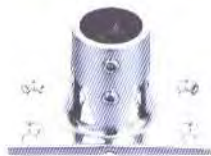

Code	D mm	L mm	W mm	H mm
H0213B	22	78.7	44	43.7
H0214B	25	82	47.3	44.1
H0214C	30	86	51.8	44

AISI 316 STAINLESS STEEL 45° WELDABLE ROUND BASE

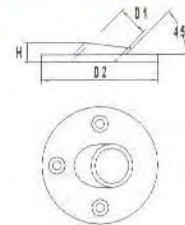

Code	D1 mm	D2 mm	H mm
H0250A	22	66	13
H0251A	25	80	10

AISI 316 STAINLESS STEEL 60° WELDABLE ROUND BASE

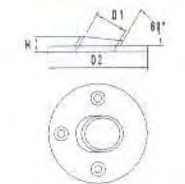

Code	D1 mm	D2 mm	H mm
H0252A	22	66	13
H0253A	25	80	16

AISI 316 STAINLESS STEEL 90° WELDABLE ROUND BASE

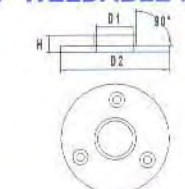

Code	D1 mm	D2 mm	H mm
H0254A	22	66	16
H0255A	25	75	16

AISI 316 STAINLESS STEEL 45° WELDABLE RECTANGULAR BASE

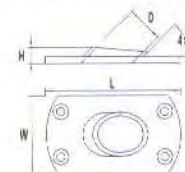

Code	D mm	L mm	W mm	H mm
H0256B	22	78	44	12.5
H0257B	25	78	44	15

AISI 316 STAINLESS STEEL 60° WELDABLE RECTANGULAR BASE

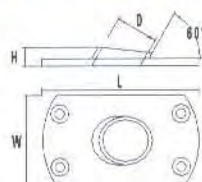

Code	D mm	L mm	W mm	H mm
H0258B	22	78	44	13
H0259B	25	78	44	14

MARINE HARDWARE

AISI 316 STAINLESS STEEL 90° WELDABLE RECTANGULAR BASE

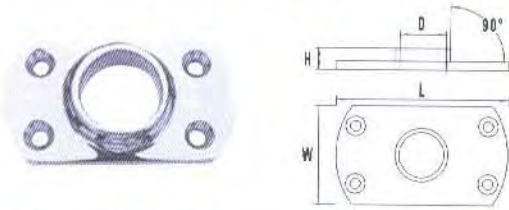

Code	D mm	L mm	W mm	H mm
H0260B	22	78	44	16
H0261B	25	78	44	16

AISI 316 STAINLESS STEEL STANCHION BASE



Code	Degree	L mm	W mm	H mm
H0015B	83°	90	56	60
H0015C	90°	90	56	60

AISI 316 STAINLESS STEEL STANCHION BASE FOR RAIL



Code	Degree	L mm	W mm	H mm
H0016B	60°	78.2	56	68
H0016C	90°	80	56	68.5

AISI 316 STAINLESS STEEL 60° STANCHION BASE



Code	D mm	H mm
H0299C	25	67
H0299A	30	105

AISI 316 STAINLESS STEEL 90° STANCHION BASE



Code	D mm	H mm
H0299D	25	69
H0299B	30	80

AISI 316 STAINLESS STEEL 60° STANCHION BASE



Code	D mm	H mm
H00100A	25	66.5
H00102A	30	61

AISI 316 STAINLESS STEEL 90° STANCHION BASE



Code	D mm	H mm
H00101A	25	56.2
H00103A	30	61.5

MARINE HARDWARE

AISI 316 STAINLESS STEEL CENTER FITTING FOR HANDRAIL



Code	D mm	H mm
H34210	22	55
H34212	25	65

AISI 316 STAINLESS STEEL END FITTING FOR HANDRAIL



Code	D mm	H mm
H34214	22	55
H34216	25	65

AISI 316 STAINLESS STEEL 90° ELBOW

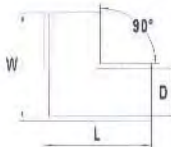

Code	D mm	L mm	W mm
H0240A	22	50	50
H0241A	25	51	51

AISI 316 STAINLESS STEEL 60° HANDRAIL TEE

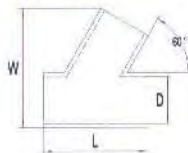

Code	D mm	L mm	W mm
H0230A	22	48	57
H0231A	25	52	60
H0231B	30	79	79

AISI 316 STAINLESS STEEL 60° RIGHT HAND HANDRAIL TEE

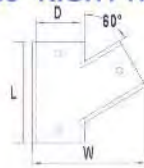

Code	L mm	H mm	W mm
H0232A	22	48	57
H0233A	25	52	60

AISI 316 STAINLESS STEEL 60° LEFT HAND HANDRAIL TEE

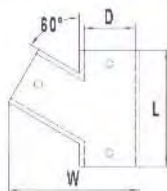

Code	L mm	H mm	W mm
H0234A	22	48	57
H0235A	25	52	60

AISI 316 STAINLESS STEEL 90° HANDRAIL TEE

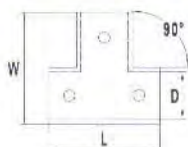

Code	L mm	H mm	W mm
H0236A	22	52	52
H0237A	25	55	55
H0237B	30	76	83

MARINE HARDWARE

AISI 316 STAINLESS STEEL 60° HANDRAIL TEE

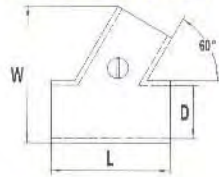
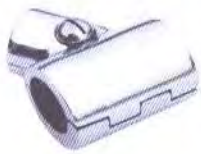

Code	L mm	H mm	W mm
H0230C	22	48	57
H0231C	25	52	60

AISI 316 STAINLESS STEEL 90° HANDRAIL TEE

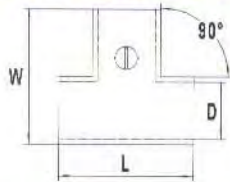
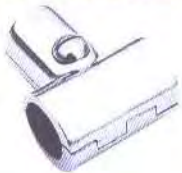

Code	L mm	H mm	W mm
H0236C	22	52	52
H0237C	25	55	55

AISI 316 STAINLESS STEEL 60° TEE CONNECTOR

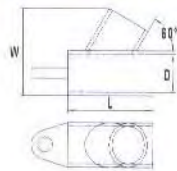

Code	L mm	H mm	W mm
H0233B	22	48	57

AISI 316 STAINLESS STEEL 90° TEE CONNECTOR

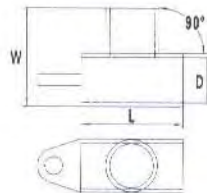

Code	L mm	H mm	W mm
H0233C	22	52	52

AISI 316 STAINLESS STEEL 90° 3-WAY TEE CONNECTOR

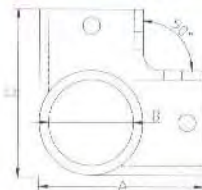

Code	L mm	H mm	W mm
H0294A	22	49.2	49.2
H0294B	25	49	49
H0294C	30	49	49

AISI 316 STAINLESS STEEL 90° 4-WAY TEE CONNECTOR

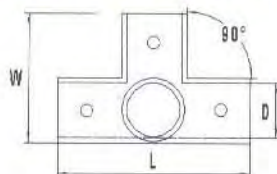

Code	L mm	H mm	W mm
H00105A	22	72.4	51
H00105B	25	71.7	51.4

AISI 316 STAINLESS STEEL 90° CROSS TEE CONNECTOR

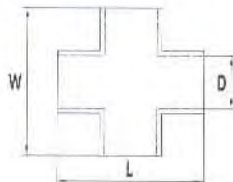

Code	L mm	H mm	W mm
H0295A	22	72.4	72.4
H0295B	25	71.7	71.7

MARINE HARDWARE

AISI 316 STAINLESS STEEL 90° 2-WAY TEE CONNECTOR

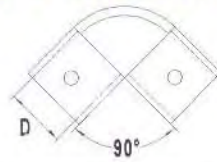

Code	D mm
H902200	22

AISI 316 STAINLESS STEEL BLIND BASE

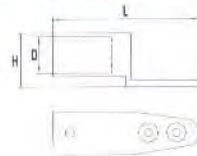

Code	D mm	L mm	H mm
H0293A	25	87	34.2

AISI 316 STAINLESS STEEL SWIVELING JOINT FOR BIMINI PIPES

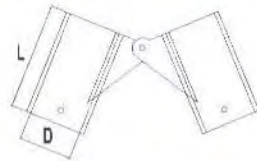

Code	D mm	L mm
H22104	22	38.5
H22105	25	39.2

AISI 316 STAINLESS STEEL SWIVELING JOINT FOR BIMINI PIPES

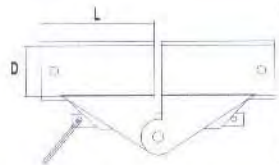
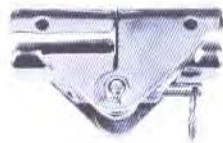

Code	D mm	L mm
H22106	30	42.1

AISI 316 STAINLESS STEEL SWIVELING JOINT FOR BIMINI PIPES

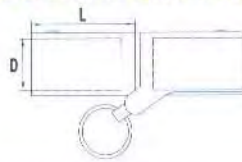
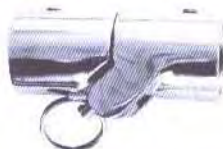

Code	D mm	L mm
H22306	22	37.8
H22206	25	38

AISI 316 STAINLESS STEEL SWIVELING JOINT FOR BIMINI PIPES



Code	D1 mm	D2 mm
H22107	17.5	20.2
H22108	17	20
H22110	19.4	22
H22112	18.8	22

AISI 316 STAINLESS STEEL BOW FORM

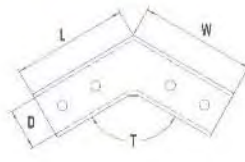

Code	D mm	L mm	W mm	T
H0242A	22	63	63	110°
H0242B	25	63	63	110°
H0243A	22	64	64	120°
H0243B	25	64	64	120°
H0244A	22	64	64	125°
H0244B	25	64	64	125°
H0245A	22	59	59	140°
H0245B	25	59	59	140°

MARINE HARDWARE

AISI 316 STAINLESS STEEL RAIL END

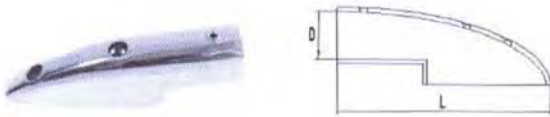

Code	D mm	L mm
H0200A	22	119

AISI 316 STAINLESS STEEL RAIL END

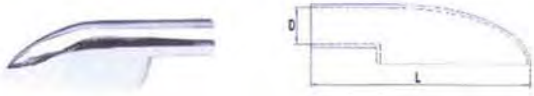

Code	D mm	L mm
H0200B	22	170
H0200C	25	170

AISI 316 STAINLESS STEEL RAIL END

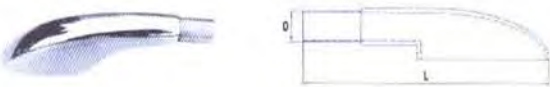

Code	D mm	L mm
H258	25	187.5

AISI 316 STAINLESS STEEL RAIL END

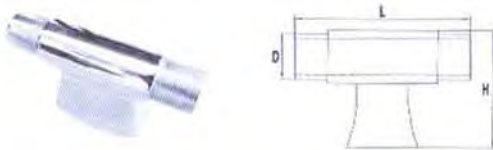

Code	D mm	L mm	H mm
H259	25	100	61

AISI 316 STAINLESS STEEL RAIL END



Code	D mm	L mm
H0201A	22	109

AISI 316 STAINLESS STEEL MAST BRACKET



Code	L mm	H mm	D mm	Degree
H3290	82.5	72.4	25	90°
H3287	82.5	72.4	25	87°
H3285	82.5	72.4	25	85°

AISI 316 STAINLESS STEEL STANCHION BASE



Code	D mm	L mm	W mm	H mm
H4943	14	85.6	40.5	33.2
H4945	20	86	42	44.4
H4946	25	90.5	45	52

MARINE HARDWARE

Pull Ring

拉环

AISI 316 STAINLESS STEEL PULL RING

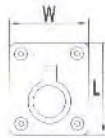

Code	L mm	W mm
H0801B	48	38

AISI 316 STAINLESS STEEL PULL RING

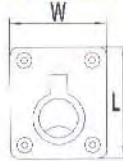

Code	L mm	W mm
H0801C	62	44

AISI 316 STAINLESS STEEL PULL RING

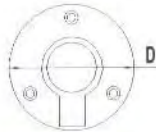

Code	D mm
H03047	50

AISI 316 STAINLESS STEEL PULL RING

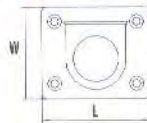

Code	L mm	W mm
H1821	75	55

AISI 316 STAINLESS STEEL PULL RING

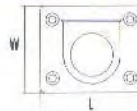

Code	L mm	W mm
H31189	75	58

AISI 316 STAINLESS STEEL PULL RING

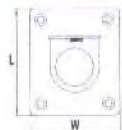

Code	L mm	W mm
H1822	38	44
H1823	65	55

AISI 316 STAINLESS STEEL PULL RING

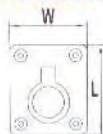

Code	L mm	W mm
H1825	57	40

AISI 316 STAINLESS STEEL PULL RING

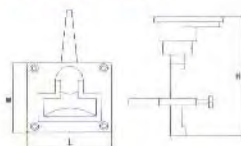

Code	L mm	W mm	H mm
H3201	79	67.2	109.8

AISI 316 STAINLESS STEEL PULL RING

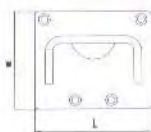

Code	L mm	W mm
H3202	76	58

MARINE HARDWARE

Lock & Latch 锁扣

AISI 316 STAINLESS STEEL TURNING LOCK

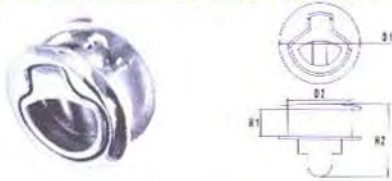

Code	D1 mm	D2 mm	H1 mm	H2 mm
H3203	62	50.5	11.5	37.4

AISI 316 STAINLESS STEEL TURNING LOCK



Code	D1 mm	D2 mm	H1 mm	H2 mm
H3206	62	50.5	11.5	37.4

AISI 316 STAINLESS STEEL TURNING LOCK



Code	D1 mm	D2 mm	H1 mm	H2 mm
H3204	62	50.5	11.5	37.4

AISI 316 STAINLESS STEEL TURNING LOCK



Code	D1 mm	D2 mm	H1 mm	H2 mm
H3205	61	49.4	20	66

AISI 316 STAINLESS STEEL LATCH

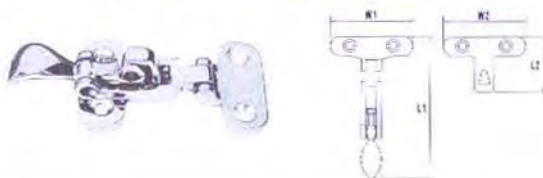

Code	L1 mm	L2 mm	W1 mm	W2 mm
H0701A	111	39.1	48.1	48.2

AISI 316 STAINLESS STEEL LATCH



Code	L1 mm	L2 mm	W1 mm	W2 mm
H0702A	121.5	33	37	37

AISI 316 STAINLESS STEEL LATCH



Code	L1 mm	L2 mm	W1 mm	W2 mm
H211	82.5	25.4	27.8	28

MARINE HARDWARE

AISI 316 STAINLESS STEEL LATCH

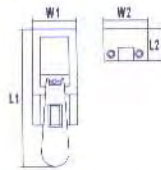

Code	L1 mm	L2 mm	W1 mm	W2 mm
H212	83.5	17.6	29.1	29.1

AISI 316 STAINLESS STEEL LATCH

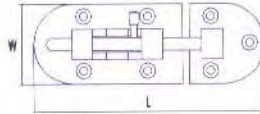

Code	L mm	W mm
H49000	90	39
H49001	108	31

AISI 316 STAINLESS STEEL LATCH



Code	Length mm	Width mm
H1011	79	26

AISI 316 STAINLESS STEEL LATCH

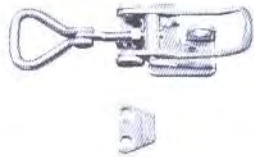

Code	Length mm	Width mm
H1012	70	21

HINGE



Code	Dimensions mm.
H0703A	90x25.5

BARREL BOLT



Code	Size mm.
H49002	50
H49003	76
H49004	102

ECCENTRIC HINGES FOR HATCHES



Code	For pipe mm.
H2250A	45x35

BARREL BOLT



Code	Size mm.
H48001	100x42.5

MARINE HARDWARE

AISI 316 STAINLESS STEEL LATCH



Code	Length mm	Width mm
H80199	76	30

AISI 304 STAINLESS STEEL LATCH

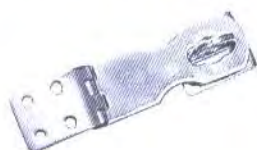

Code	Length mm	Width mm
H80200	71	25

AISI 316 STAINLESS STEEL BELT LATCH

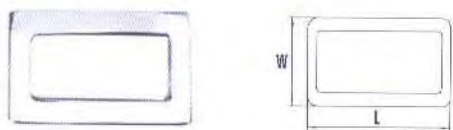

Code	L mm	W mm
H341	65	40

AISI 316 STAINLESS STEEL BELT LATCH

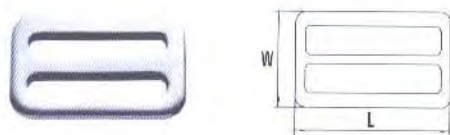

Code	L mm	W mm
H342	62	34
H343	35	25

AISI 316 STAINLESS STEEL BELT LATCH

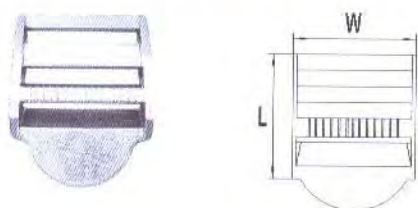

Code	L mm	W mm
H230-070	31	32.3
H230-071	48	38

Antenna Base 天线座

AISI 316 STAINLESS STEEL ANTENNA BASE



Code	L mm	W mm	D mm
H0909A	93	64	25

MARINE HARDWARE

Stanchion & Bracket 支撐

AISI 316 STAINLESS STEEL STANCHION



Code	D mm	L mm
HS0101	25	610
HS0102	25	750
HS0103	25	900
HS0104	25	1200

AISI 316 STAINLESS STEEL STANCHION



Code	D mm	L mm
HS0201	25	465
HS0202	25	610
HS0203	25	725

AISI 316 STAINLESS STEEL STANCHION



Code	D mm	L mm
HS0301	25	465
HS0302	25	610
HS0303	25	725

AISI 316 STAINLESS STEEL STANCHION



Code	D mm	L mm
HS0401	14	400
HS0402	20	600
HS0403	25	800

AISI 316 STAINLESS STEEL STANCHION



Code	D mm	L mm
HS0501	20	610
HS0502	25	750
HS0503	25	900
HS0504	25	1200

AISI 316 STAINLESS STEEL TABLE BRACKET



Code	L mm	W mm
H01013	300	165

MARINE HARDWARE

AISI 304 STAINLESS STEEL HATCH COVER PULL



Code	Dia. mm	Base Dia. mm	Length mm
H1232S	6.4	31.8	84.4
H1232L	6.4	31.8	113
H1232R3	6.4	31.8	54.3

AISI 304 STAINLESS STEEL HATCH ADJUSTER



Code	Dia. mm	Length mm
H2912S	11	210
H2913S	14.5	260

AISI 304 STAINLESS STEEL HATCH ADJUSTER



Code	Dia. mm	Length mm
H2914S	11	210
H2915S	14.5	260

AISI 304 STAINLESS STEEL HATCH ADJUSTER WITH WIRE ROPE



Code	Dia. mm	Length mm
H2912SW	11	210
H2913SW	14.5	260

AISI 304 STAINLESS STEEL HATCH ADJUSTER WITH WIRE ROPE



Code	Dia. mm	Length mm
H2914SW	11	210
H2915SW	14.5	260

AISI 304 STAINLESS STEEL HATCH ADJUSTER



Code	L mm	D mm
H82006D	350	16
H82006	430	16

AISI 304 STAINLESS STEEL HATCH ADJUSTER



Code	L mm
H82007	390

MARINE HARDWARE

Other Hardware 其他五金

ACCESSORIES



Code	Thread
H10124	90mm

HINGE



Code	I.D. mm.
H8001A	163X57
H8001B	177X60

AISI 316 STAINLESS STEEL CABLE GLAND

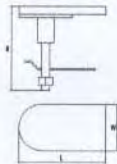

Code	L mm	W mm	H mm
H49005	118.5	114.8	90.5

AISI 316 STAINLESS STEEL WATER SKI TOW

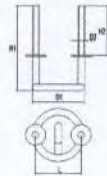

Code	L mm	D1 mm	D2 mm	H2 mm	H2 mm
H1960	43	62	10	102	65.3
H1961	62	75	10	118	65.3

AISI 316 STAINLESS STEEL FOLDING STEP

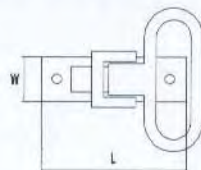

Code	L mm	W mm
H49006A	130	85
H49006B	135	110

AISI 316 STAINLESS STEEL DRAIN PLUG

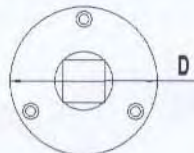

Code	D mm
H12000	50

AISI 316 STAINLESS STEEL DRAIN PLUG



Code	D mm
H0227A	22
H0227B	25

MARINE HARDWARE

AISI 316 STAINLESS STEEL RUB STRAKE



Code	Width mm	Length mm	Screws
H2090SA	19	203	10#
H2091SA	19	304	10#
H2092SA	19	457	10#
H2093SA	19	610	10#
H2090SA1	25.4	203	10#
H2091SA1	25.4	304	10#
H2092SA1	25.4	457	10#
H2093SA1	25.4	610	10#

TELESCOPIC BOAT HOOKS



Code	Open Length mm	Section
H1245A2	2180	2
H1245A3	2335	3

AISI 316 STAINLESS STEEL BOAT HOOK



Code	D mm	H mm
H0028	34	170
H0034	41	188

AISI 316 STAINLESS STEEL HOOK

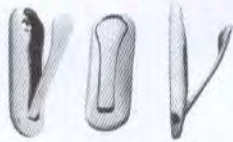

Code
H49008

AISI 316 STAINLESS STEEL HOOK



Code
H49009

COPPER DIP CHROME DOOR STOPPER



Code	D mm	H mm
H1242	49	61

FORK TO MOUNT HOODS ON INFLATABLE ROWLOCKS



Code	Length mm.
H22103	9.8

HINGE



Code	A mm	B mm	C mm	D mm	E mm	F mm
H8002A	165	40	6	68	6	31

MARINE HARDWARE

HINGE

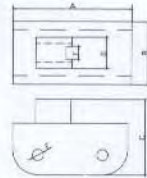

Code	A mm	B mm	C mm	D mm	E mm	F mm
H8003A	70	61	95	50	8	9

HINGE

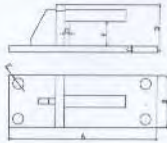

Code	A mm	B mm	C mm	D mm	E mm	F mm	G mm
H8004A	165	40	6	68	6	31	8

STANCHION

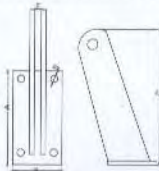

Code	A mm	B mm	C mm	D mm	E mm
H8005A	92	56	133	6	16

HINGE

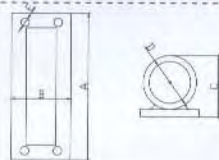

Code	A mm	B mm	C mm	D mm	E mm
H8006A	100	40	42	32	6

EYE PLATE

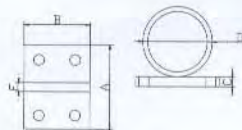

Code	A mm	B mm	C mm	D mm	E mm
H49004	51	40	6	42.5	5.5

HINGE



Code	A mm	B mm	C mm	D mm	E mm
H8008A	50	24	60	8	5

CAR PART

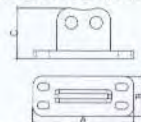

Code	A mm	B mm	C mm
H21300	160	61	76

CAR PART

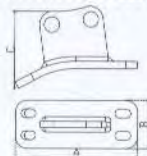

Code	A mm	B mm	C mm
H21299	160	61	73

CAR PART



Code	Thread
H21299-B2	160x60x100mm

S.STEEL HOOK

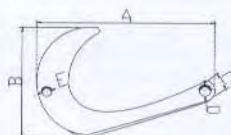

Code	A mm	B mm	C mm	D mm	E mm
H420101	150	100	30	15	9

MARINE HARDWARE

Steering Wheel 方向盘

AISI 304/316 STAINLESS STEEL STEERING WHEEL



Code	Size mm	Spoke	Shaft mm	Color
H0101	343	5	20/25	White
H0102	343	5	20/25	Black
H0103	400	5	20/25	White
H0104	400	5	20/25	Black

AISI 304/316 STAINLESS STEEL STEERING WHEEL



Code	Size mm	Spoke	Shaft mm
H0301	343	5	20/25
H0302	400	5	20/25
H0303	460	5	20/25
H0304	500	5	20/25

AISI 304/316 STAINLESS STEEL STEERING WHEEL WITH KNOB



Code	Size mm	Spoke	Shaft mm
H0401	343	5	20/25
H0402	400	5	20/25

AISI 304/316 STAINLESS STEEL STEERING WHEEL WITH KNOB



Code	Size mm	Spoke	Shaft mm
H0501	343	3	20/25
H0502	400	3	20/25

S.S DESTROYER WHEEL

made of 304 Stainless Steel W/SS 316 Casting Hub



Code	Size	Dish	Shaft	Spoke
H21301	13.5"	25Deg	3/8"	5
H21302	15.5"	25Deg	3/8"	5
H21303	15.5"	10Deg	3/8"	5
H21304	18"	10Deg	3/8"	5
H21305	20"	10Deg	7/16"	5
H21306	22"	10Deg	7/16"	5

S.S WHEEL WITH KNOB 5-SPOKE

made of 304 Stainless Steel W/SS 316 Casting Hub



Code	Size	Shaft	Dish
H21201	15-1/2"	3/4"	25Deg
H21202	13-1/2"	3/4"	25Deg
H21203	11"	3/4"	25Deg

S.S WHEEL AND PVC FOAM COVER 6-SPOKE

made of 304 Stainless Steel W/SS 316 Casting Hub



Code	Size	Shaft	Dish	Foam
H1601	15-1/2"	3/4"	25Deg	Black
H1602	15-1/2"	3/4"	25Deg	Gray
H1603	15-1/2"	3/4"	25Deg	Black
H1604	15-1/2"	3/4"	25Deg	Gray

MARINE HARDWARE

排水及通风系列

PLUMBING & VENTILATION

QUALITY FIRST, COUSTOMERS FIRST

Thru-Hull & Vent 出水口和通风口

AISI 316 STAINLESS STEEL THRU-HULL

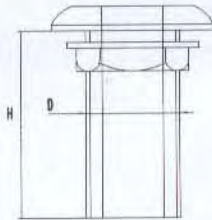

Code	D	H mm
H0101A	3/8"	53.2
H0102A	1/2"	61
H0103A	3/4"	70.1
H0104A	1"	72.8
H0105A	1-1/4"	78.6
H0106A	1-1/2"	79.3
H0107A	2"	95.1
H0108A	2-1/2"	115.5
H0109A	3"	120

AISI 316 STAINLESS STEEL THRU-HULL

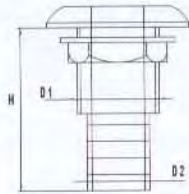

Code	D1	D2 mm	H mm
H0101B	3/8"	14	53.2
H0102B	1/2"	18.3	61
H0103B	3/4"	22.7	70.1
H0104B	1"	29.9	72.8
H0105B	1-1/4"	38.7	78.6
H0106B	1-1/2"	43.5	79.3
H0107B	2"	55.8	95.1
H0108B	2-1/2"	64	98
H0109B	3"	76.5	98

AISI 316 STAINLESS STEEL THRU-HULL

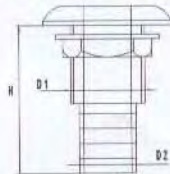

Code	D1	D2 mm	H mm
H33102	1/2"	14	87
H33103	3/4"	18	96
H33104	1"	24.5	95.5
H33105	1-1/4"	32	87
H33106	1-1/2"	38	97

THRU HULL FOR HOSE

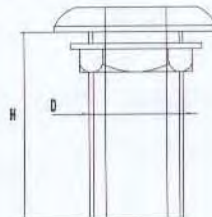

Code	Thread
H42283	1"
H42284	1-1/4"
H42285	1-1/2"

MARINE HARDWARE

AISI 316 STAINLESS STEEL THRU-HULL

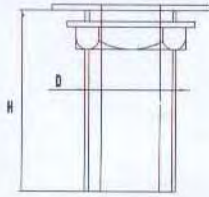

Code	D	H mm
H0101D	3/8"	53.2
H0102D	1/2"	61
H0103D	3/4"	70.1
H0104D	1"	72.8
H0105D	1-1/4"	78.6
H0106D	1-1/2"	79.3
H0107D	2"	95.1

AISI 316 STAINLESS STEEL THRU-HULL

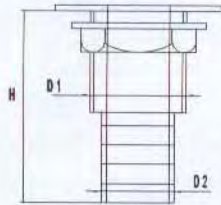

Code	D1	D2 mm	H mm
H0101E	3/8"	14	53.2
H0102E	1/2"	18.3	61
H0103E	3/4"	22.7	70.1
H0104E	1"	29.9	72.8
H0105E	1-1/4"	38.7	78.6
H0106E	1-1/2"	43.5	79.3
H0107E	2"	55.8	95.1

AISI 316 STAINLESS STEEL COCKPIT



Code	D mm	H mm
H11840	38	115

AISI 316 STAINLESS STEEL COCKPIT

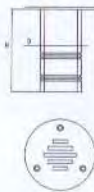

Code	D mm	H mm
H11850	51	79.6

AISI 316 STAINLESS STEEL COCKPIT

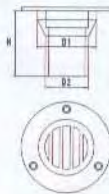

Code	D1 mm	D2 mm	H mm
H10125-57	57.6	37.1	57.2

AISI 316 STAINLESS STEEL FUEL TANK VENT

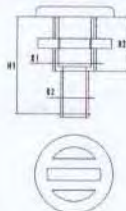

Code	D1 mm	D2 mm	H1 mm	H2 mm
H0912	27	16.5	57	29

MARINE HARDWARE

AISI 316 STAINLESS STEEL INTAKE STRAINER



Code	D	H mm
H0101C	3/8"	65.5
H0102C	1/2"	65.8
H0103C	3/4"	81.3
H0104C	1"	76.4
H0105C	1-1/4"	79.4
H0106C	1-1/2"	80.5
H0107C	2"	90
H0108C	2-1/2"	125
H0109C	3"	130.5

AISI 316 STAINLESS STEEL SCUPPER



Code	D	H mm
H11901	1/2"	65
H11902	3/4"	65
H11903	1"	75
H11904	1-1/4"	79
H11905	1-1/2"	83
H11906	2"	90

VENT



STAINLESS STEEL CASE AND BLACK PLASTIC BASE

Code	L mm	W mm	H mm
H9140	145	111	81

OVAL VENT W/DECK PLATE

made of Investment Cast 316 Stainless Steel



Code	Plate O.D.	Plate I.D.	Height
H01360RW	5-1/2"	4"	10"

AISI 316 STAINLESS STEEL EXHAUST VENT



Code	D1 mm	D2 mm	H1 mm	H2 mm
H38401	35	40	20	75
H38402	40	45	20	75
H38403	45	50	21	80
H38404	55	60	21	80
H38406	67	75	19	100
H38407	73	90	19	110
H38408	90	100	23.5	120
H38409	100	110	23.5	120
H38410	113	125	23.5	140

AISI 316 STAINLESS STEEL CABLE GLAND



Code	D1 mm	D2 mm	H1 mm	H2 mm	R mm
H35100	35.5	30.1	110	30	46.2

MARINE HARDWARE

AISI 316 STAINLESS STEEL CABLE GLAND



Code	D1 mm	D2 mm	H1 mm	R mm
H35101	35.5	30.1	70	50

AISI 316 STAINLESS STEEL TANK VENT



Code	D mm	H1 mm	H2 mm	H3 mm
H28780	16	84	28	70

AISI 316 STAINLESS STEEL TANK VENT



Code	D mm	H1 mm	H2 mm	H3 mm
H28781	16	64	28	49

AISI 316 STAINLESS STEEL TANK VENT



Code	D mm	H1 mm	H2 mm	H3 mm
H28790	16	84	28	70

AISI 316 STAINLESS STEEL TANK VENT



Code	D mm	H1 mm	H2 mm	H3 mm
H28791	16	64	28	49

AISI 304 STAINLESS STEEL VENT



Code	L mm	W mm
H00151	127	66
H00152	120	120
H00153	230	115
H00154	360	185
H00155	228	127

AISI 304 STAINLESS STEEL VENT



Code	L mm	W mm
H501	127	88
H569	91	88
H9283	260	88

AISI 304 STAINLESS STEEL VENT



Code	D mm
H00579	150
H00578	125
H00560	121
H00561	103

MARINE HARDWARE

AISI 304 STAINLESS STEEL VENT

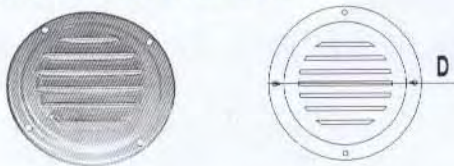

Code	D mm
H0057I	102
H0057E	121
H0056J	126

AISI 304 STAINLESS STEEL VENT



Code	D mm
H9246	100

AISI 304 STAINLESS STEEL VENT



Code	D mm
H9247	227

AISI 316 STAINLESS STEEL VENT COVER



Code	L mm	W mm	H mm
H0045A	127	66	66
H0045B	120	120	120

PLASTIC VENT COVER



Code	L mm	W mm	H mm	Color
H561	77	68	28	White Or Black
H563	64	59	26	White Or Black

END COVER

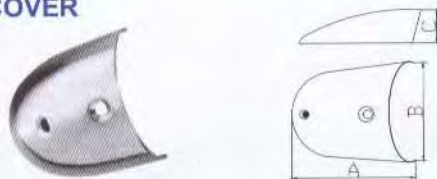

Code	For pipe mm.
H12001	83x60x35.5

WATER FILER

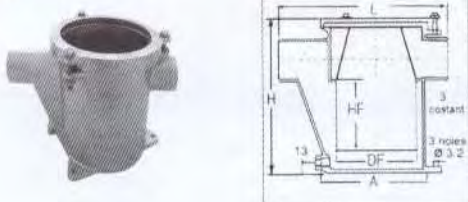

Outlets-Abflub-ebouts mesures-Made-mesures mm

Code	L	A	B	DF	DF	H
H65302	3/4"	180	123	96	86	142
H65303	1"	180	123	96	86	142
H65304	1-1/4"	200	143	147	105	200
H65305	1-1/2"	200	143	147	105	200
H65306	2"	200	160	155	125	220

MARINE HARDWARE

Deck Filler 油液口

AISI 316 STAINLESS STEEL DECK FILLER

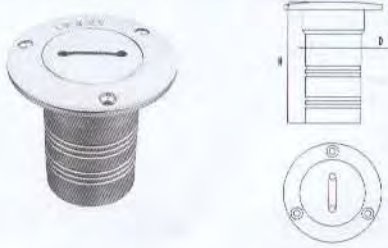

Code	Model	D mm	H mm
H0840	FUEL	38	80
H0841	FUEL	50	80
H0842	DIESEL	38	80
H0843	DIESEL	50	80
H0844	WASTE	38	80
H0845	WASTE	50	80
H0846	WATER	38	80
H0847	WATER	50	80
H0848	GAS	38	80
H0849	GAS	50	80

AISI 316 STAINLESS STEEL DECK FILLER



Code	Model	D mm	H mm
H0850	FUEL	38	78
H0851	FUEL	50	97
H0852	DIESEL	38	78
H0853	DIESEL	50	97
H0854	WATER	38	78
H0855	WATER	50	97
H0856	WASTE	38	78
H0857	WASTE	50	97

AISI 316 STAINLESS STEEL DECK FILLER



Code	Model	D mm	H mm
H0850R	FUEL	38	87.1
H0851R	FUEL	50	87.1
H0852R	DIESEL	38	87.1
H0853R	DIESEL	50	87.1
H0854R	WATER	38	87.1
H0855R	WATER	50	87.1
H0856R	WASTE	38	87.1
H0857R	WASTE	50	87.1

AISI 316 STAINLESS STEEL DECK FILLER



Code	Model	D mm	H mm
H0860	FUEL	38	87.1
H0861	FUEL	50	87.1
H0862	DIESEL	38	87.1
H0863	DIESEL	50	87.1
H0864	WATER	38	87.1
H0865	WATER	50	87.1
H0866	WASTE	38	87.1
H0867	WASTE	50	87.1

AISI 316 STAINLESS STEEL DECK FILLER



Code	Model	D mm	H mm
H0906	WATER	33	65
H0908	DIESEL	54	80
H0910	WASTE	50	98

AISI 316 STAINLESS STEEL DECK FILLER



Code	Model	D mm	H mm
H0900	FUEL	50	87
H0901	WATER	38	86
H0902	DIESEL	50	87
H0903	WASTE	38	86
H0904	FUEL	38	86

MARINE HARDWARE

Ball Valve & Pipe Fitting 球阀和管件

90° PIPE ELBOWS MALE-FEMALE



Code	Thread
H12401	3/8"
H12402	1/2"
H12403	3/4"
H12404	1"
H12405	1-1/4"
H12406	1-1/2"
H12407	2"

HOSE ADAPTER FEMALE 90°



Code	Thread	Hose adapter mm.
H19401	1/2"	19
H19402	3/4"	25
H19403	1"	30
H19404	1-1/2"	39
H19405	1-1/2"	44
H19406	2"	56

PIPE CAP



Code	Thread
H12301	3/8"
H12302	1/2"
H12303	3/4"
H12304	1"
H12305	1-1/4"
H12306	1-1/2"
H12307	2"

TEE PIPE FEMALE-FEMALE-FEMALE



Code	Thread
H31801	3/8"
H31802	1/2"
H31803	3/4"
H31804	1"
H31805	1-1/4"
H31806	1-1/2"

HOSE ADAPTER 90° MALE



Code	Thread	Hose adapter mm.
H19604	1/2"	20
H19606	3/4"	25
H19608	1"	30
H19610	1-1/4"	38

90° PIPE ELBOWS FEMALE-FEMALE



Code	Thread
H32601	3/8"
H32602	1/2"
H32603	3/4"
H32604	1"
H32605	1-1/4"
H32606	1-1/2"
H32607	2"

MALE HOSE CONNECTOR



Code	Thread	Hose adapter mm.
H30600	3/8"	12
H30601	3/8"	15
H30602	1/2"	15
H30603	1/2"	20
H30604	3/4"	20
H30605	3/4"	25
H30606	1"	25
H30607	1"	30
H30608	1-1/4"	35
H30609	1-1/4"	40
H30610	1-1/2"	45
H30611	2"	50
H30612	2"	60
H30613	2-1/2"	70
H30614	3"	78
H30615	1-1/4"	38
H30619	1-1/2"	40

MARINE HARDWARE

DOUBLE PIPE NIPPLES



Code	Thread
H12501	3/8"
H12502	1/2"
H12503	3/4"
H12504	1"
H12505	1-1/4"
H12506	1-1/2"
H12507	2"

DOUBLE PIPE NIPPLES

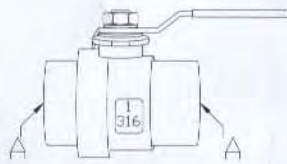

Code	Thread
H72101	3/8"
H72102	1/2"
H72103	3/4"
H72104	1"
H72105	1-1/4"
H72106	1-1/2"
H72107	2"
H72108	2-1/2"
H72109	3"

HEX PIPE REDUCING COUPLING

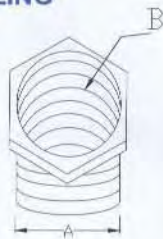

Code	Thread
H32101	3/8"x1/4"
H32102	1/2"x3/8"
H32103	3/4"x1/2"
H32104	1"x3/4"
H32105	1-1/4"x1"
H32106	1-1/2"x1/4"
H32107	2"x1-1/2"
H32108	2-1/2"x2"
H32109	3"x2-1/2"

FEMALE HOSE CONNECTOR



Code	Thread	Hose adapter mm.
H21001	3/8"	15
H21002	1/2"	15
H21003	1/2"	20
H21004	3/4"	20
H21005	3/4"	25
H21006	1"	25
H21007	1"	30
H21008	1-1/4"	35
H21009	1-1/4"	40
H21010	1-1/2"	45
H21011	2"	50

PIPE ELBOWS FEMALE-FEMALE



Code	Thread
H22201	3/8"
H22202	1/2"
H22203	3/4"
H22204	1"
H22205	1-1/4"
H22206	1-1/2"
H22207	2"

PIPE COUPLING



Code	Thread
H37001	3/8"
H37002	1/2"
H37003	3/4"
H37004	1"
H37005	1-1/4"
H37006	1-1/2"
H37007	2"